



LED Street Light

ST16 Series

LED Industrial Lighting Professor !

Feature



High efficiency TRIDONIC led driver

Dimmable built-in constant current LED Driver
 Dimming range 5 – 100 % (min. 10 mA)
 The use of LED high efficiency TRIDONIC driver, conversion of up to 92%, Max. output power 60 W
 Power factor > 0.95, IP20 protection class, suitable for indoor
 Output current adjustable between 200 – 1,000 mA
 Nominal life-time of 100,000 h and 8-year guarantee
 For luminaires of protection class I and protection class II
 Temperature protection as per EN 61347-2-13 C5e

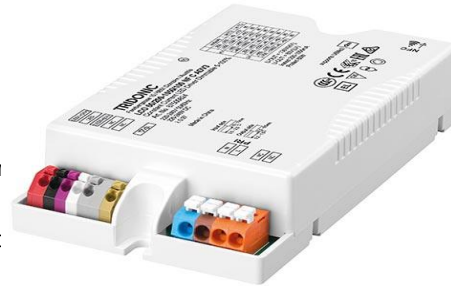

MST RecLED 224x50mm 2x8

Long life-time
 Re-workable push-in terminals enabling easy connection
 Compliance and approval: CE
 Case temperature $T_c = 95^\circ\text{C}$
 Tolerance range for optical and electrical data $\pm 10\%$
 Min. driving current 200mA
 Max. torque for fixing: 0,5Nm



LED housing

- The installation angle is adjustable, easy to use.
- With entire aluminum housing structure, the led contact the heat sink closely, optimize heat dissipation.
- Light body design is small, more conducive to transport and installation and maintenance.
- Specially designed for outdoor using, with self-leaning mechanism lead to less dust and water accumulation, reducing, maintenance, IP65 rated.
- Separate drive box design, enhancing the driver's efficiency and stability.
- The package uses a thick Paul Lee plus K = K plus a hard carton to ensure a variety of complex transport.



Product Specification



SKU	ML7000-10000						
Watts	30W/50W	60W	100W	120W	150W	180W	200W
Dimension	520*212*90	616*259* 186		676*303*186		850*366*198	
Color of Body	Mixed Gray						
LED Brand	MST ReLed 2x8						
Whole lamp efficiency	130w~160lm/w						
Driver Brand	TRIDONIC,OSRAM						
Power Factor	>0.95						
Dimming method	1-10V / Timer / DALI						
Input Voltage	AC100-277V						
CCT	4000K 5000K						
CRI	Ra> 70 or Ra >80						
Lens Type	LEDiL						
Material	Die-casting Aluminum Housing & PC lens & Glass						
IP Grade	IP66						
Life span	100000Hours						
Working temp	-40℃~+60℃						
Surge Protection	10KV / 20KV						
Sensor	Daylight Sensor						
Warranty	5 years						

	Led modul	Typ. power P [W]	Luminous flux Φ [lm]	Typ. forward voltage Vf [V]	Efficacy [lm/W]	IP
1	ML7000	48	7081	46	148	66
2	ML14000	96	14162	92	148	66
3	ML20000	144	21200	138	148	66



Dimension (unit: mm)

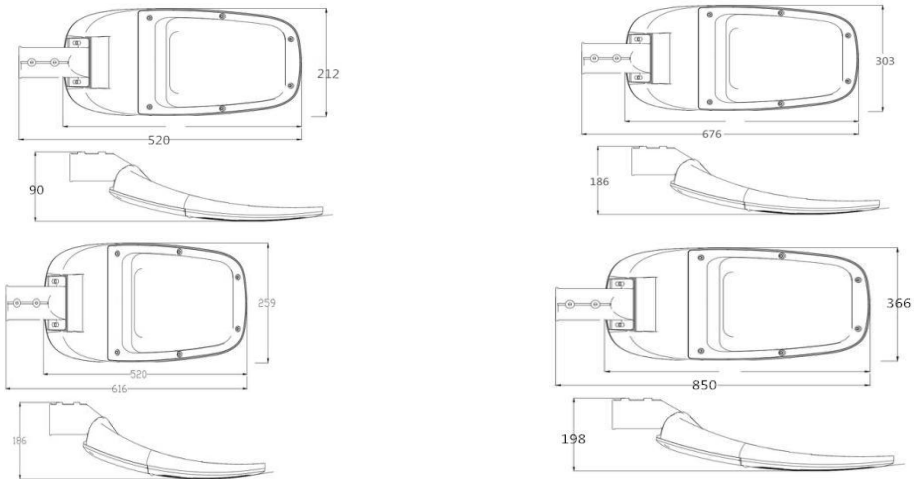

Application



Highway ,city cross road, urban street and boulevard; School, park, factory,residential district.

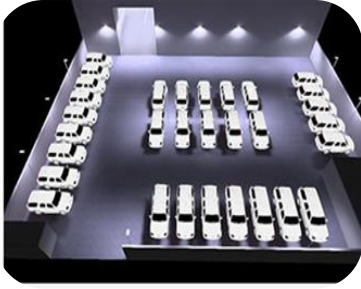

Light distribution curve

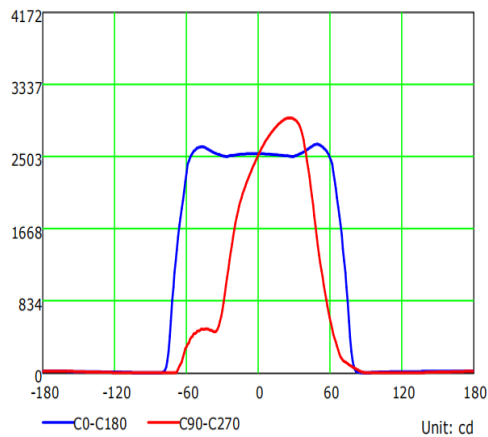
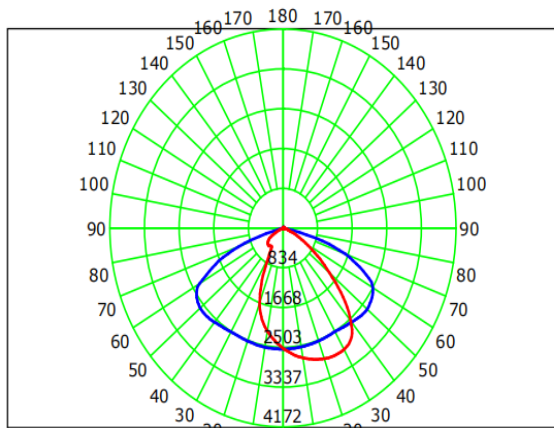

Installation

Note:

1. In case of fire ,explosion,electronics shock,the install,inspect and maintenance must be operated by professional people.
2. Please make sure the power off before operation!
3. Luminaries must connect earth cable
4. Please make the volatege supplied is available for the lumiaries!
5. Please make the luminaries working under the limited working temperature!

Maintenance manual

1. Cut off power before maintenance
2. Clean the glass of led street light regular to keep good light transmission
3. Clean the dusk on the surface and heat sink regular to keep good heat dissipation.
4. Do not use water or corrosive liquid to clear the lamp,dry cloth is better



A.

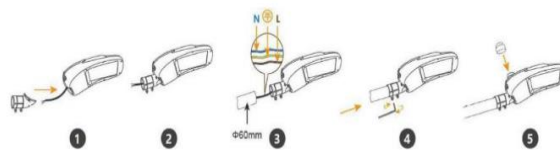

B.

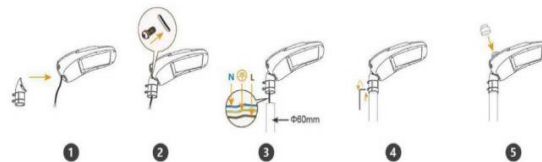

5. Replace LED Driver: use screwdriver to open cover,fetch out the driver,You can see three AC wires,Match brown wire with "L",blue with "N",kelly or yellow with"G".The red or white wire on driver is the positive electrode,black wire is the negative electrode,Notice,please confirm the positive and negative electorde has not met extremely instead.